



## KDC270 & KDC280 Charging Adaptor Installation Manual



\* All pictures shown are for illustration purposes only.  
Actual product may vary.

Follow these same instructions for installing Adaptor  
with or without Bumper to charge KDC270/280  
utilizing 4-slot Charging Cradle.

### Additional KDC270/280 Accessories:

- Protective Boot



116 Village Blvd, Ste 305, Princeton, NJ 08540  
+1 609-256-4700 p | +1 609-228-4373 f  
info@koamtac.com | www.koamtac.com

### What's in the box?

- Charging Cradle
- Adaptor
- Bumper

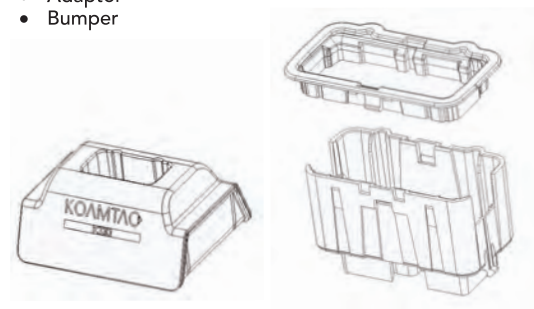

\*KDC270/280 sold separately

## Installation Instructions

For charging KDC270/280 **with** protective boot

1. Align ridges on Adaptor with those on Charging  
Cradle. Insert firmly, until you hear a click. (A,B)

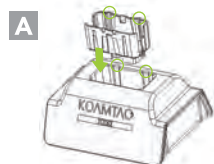

2. Insert KDC270/280 into Charging Cradle with  
Adaptor, ensuring KOAMTAC logos face same  
direction. (C,D)



Charging KDC270/280 with lanyard attached  
(with or without protective boot)

If lanyard is connected to KDC270/280, pull lanyard to  
back of KDC270/280 and align with ridge when inserting  
KDC270/280 into the cradle. (E,F)

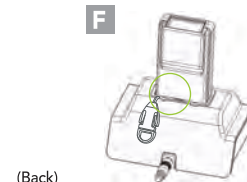

(Back)

# Installation Instructions

For charging KDC270/280 **without** protective boot

1. Align the ridges on bumper to the ridges on Adaptor.  
Insert Bumper into Adaptor until you hear a click. (G,H)

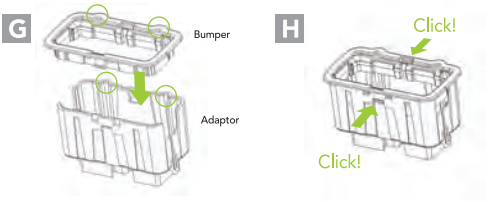

2. Insert connected Bumper and Adaptor into the  
Charging Cradle firmly, until you hear a click. (I,J)

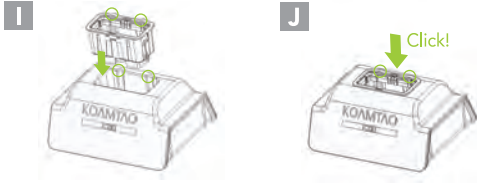

3. Insert KDC270/280 into Charging Cradle with Bumper  
and Adaptor, ensuring KOAMTAC logos face same  
direction. (K,L)

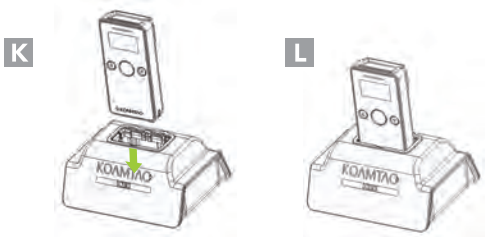

# Removal Instructions

Remove Adaptor (without bumper) from Charging Cradle  
utilzing fingers and a standard (flat-head) screwdriver. (M,N)

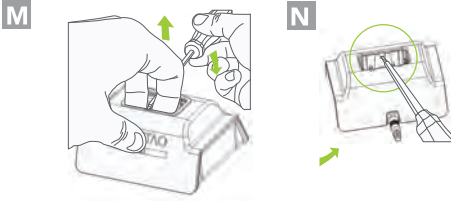

Remove Bumper and Adaptor from Charging Cradle using  
fingers. (O)

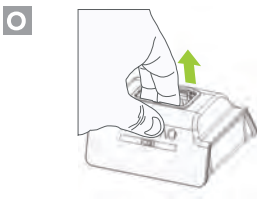

# Separating Bumper and Adaptor

Place standard (flat-head) screwdriver at bottom of  
connection point of Bumper and Adaptor. Push Bumper  
point in and up, then pull Bumper out of Adaptor. (P,Q)

