

## What's in the Box?

- ▶ KDC280
- ▶ 1-Slot Charging Cradle
- ▶ L-Shaped DC Jack USB Cable & Power Supply
- ▶ KBLED50 BLE Dongle
- ▶ Type-C USB Cable
- ▶ KDC® Lanyard
- ▶ Lanyard & Cable Installation Guide
- ▶ KOAMTACON Guide

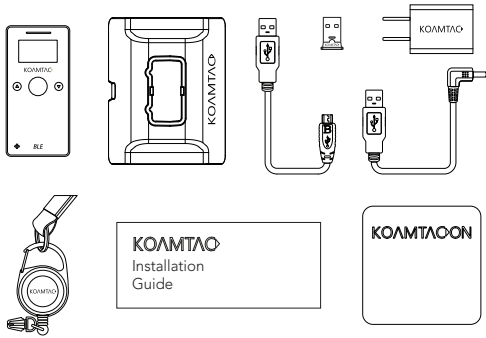

## Powering On/Off

### Power On

Press and hold the SCAN button for 3 seconds.

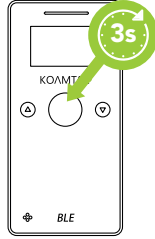

### Power Off

Press and hold the SCAN and DOWN buttons for 3 seconds.

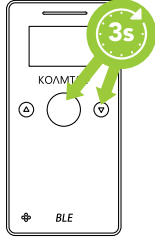

## Additional Accessories

- ▶ 1-Slot and 4-Slot Charging Cradles
- ▶ 650mAh Battery

## KDC280 Models

- ▶ KDC280L-BLE 1D Laser Bluetooth Barcode Scanner
- ▶ KDC280D-BLE 1D CCD Bluetooth Barcode Scanner
- ▶ KDC280C-BLE 2D Imager Bluetooth Barcode Scanner

Visit our website for more information.

# KOAMTAC

116 Village Blvd, Ste 305, Princeton, NJ 08540  
+1 609-256-4700 p | +1 609-228-4373 f  
info@koamtac.com | www.koamtac.com

# KOAMTAC

## KDC280 BLE Scanning Package Mini Guide



## Basic Operation

1. Aim the KDC directly at the barcode and press the SCAN button, ensuring the beam covers the barcode horizontally.



2. A successful scan (A) will sound 1 beep, show a green LED, and display the scanned info on the screen. An unsuccessful scan (B) will sound 5 beeps, show a red LED, and display "Read Failed" on the screen.

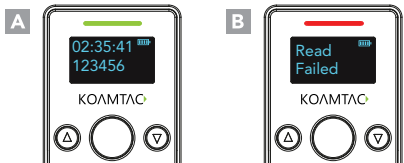

## Pairing to Your Computer

We recommend downloading the KDC drivers from our website to ensure maximum performance and lessen the chance of pairing issues.

To download the drivers, please visit:  
[www.koamtac.com/support/downloads/drivers/](http://www.koamtac.com/support/downloads/drivers/)

1. Locate the KBLED50 BLE Dongle with dongle tag.



## Pairing to Your Computer

2. Insert the BLE Dongle into your computer's USB port.\* Currently, the KBLED50 BLE Dongle is only compatible with Microsoft Windows 7/8/10.

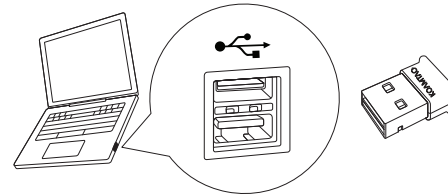

3. Power on the KDC280 by pressing and holding the SCAN button for 3 seconds.

## Pairing to Your Computer

4. Using the KDC280, scan the QR Code on the dongle tag to begin the pairing process.



5. The KDC will pair to your computer. If successful, the KDC will beep and display "Bluetooth Connected" on the screen.

\* If your computer does not recognize the dongle, you may need to remove the dongle tag from the BLE Dongle. Keep the tag close, as it is needed to pair the device.

## KTSync & SDK

KTSync® is a program which communicates with the KDC via Bluetooth. It enables users to read and store data. KTSync is compatible with iOS, Android, Windows, and Mac. It also supports wedging and downloading data from the KDC.

For more information about KTSync, please visit: [www.koamtac.com/support/downloads/applications](http://www.koamtac.com/support/downloads/applications)

The Software Development Kit (SDK) is the perfect solution for creating a custom application to collect data utilizing your KDC. The KOAMTAC SDK covers all major development platforms: Android, iOS, Tizen, Windows, Xamarin, and Cordova. Developers may take advantage of the complimentary SDK and enjoy the full benefits of the KOAMTAC Developer Program.

For more information regarding the KOAMTAC Developer Program or to request the latest SDKs, visit: [www.koamtac.com/support/downloads/sdk](http://www.koamtac.com/support/downloads/sdk) or e-mail [sdk@koamtac.com](mailto:sdk@koamtac.com).

## Specs

### Functionality

Memory Flash ROM: 1MB Program, 5MB User Data  
Memory RAM: 256KB  
Can store more than 250,000 barcodes (EAN-13)

### Wedging & Synchronization

Store to a file or transfer to an application  
Keyboard wedge function  
Add-on prefixes and suffixes  
Barcode option selection

### Scan Range (20mil Code39)

Laser/CCD: 1.97" to 18.11" (50 mm to 460 mm)  
Imager: 2.36" to 18.35" (60 mm to 466 mm)

## KOAMTACON

The first application suite of its kind, KOAMTACON is a data collection cloud suite designed specifically to be used with KDC Bluetooth barcode scanners, RFID readers, and Magnetic Stripe Readers (MSR) to collect data in any situation.

With apps ranging from ticketing to warehouse management, KOAMTAC has you covered. It's never been so easy to collect data via barcodes, RFID, or Magnetic Stripe.

KOAMTACON is:

- ▶ Simple to maintain
- ▶ Easy to use
- ▶ Cloud-based
- ▶ Compatible with any device

For more information please visit: [www.koamtac.com](http://www.koamtac.com)



## Specs

### Interfaces

Bluetooth® Low Energy 5.0: HID (Android/iOS/Windows), SPP (Optional Secure Mode)  
Type-C USB: Flash Memory (Windows), USB HID, USB Serial (Android with OTG cable / Windows)

### User Environment

Ingress Protection Rating: IP65  
Drop Spec: 5' (1.5 m)  
Operating: 14°F to 122°F (-10°C to 50°C)  
Storage: -4°F to 140°F (-20°C to 60°C)  
Humidity: 5% to 95% (non-condensing)

### Supporting OS

Android / iOS / Mac OS X / Windows

## KDC280 Diagram

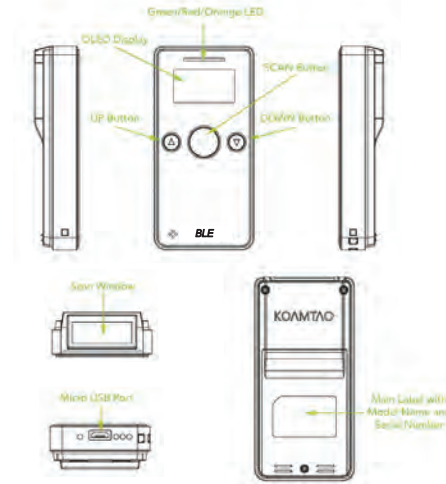

## Helpful Barcodes

Enable Beep Sound



Disable Beep Sound



## KDC280 Accessories



### Protective Rubber Boot

The Protective Boot adds shock absorption to your KDC, protecting it from drops and falls that could be damaging.



### KDC280 4-Slot Charging Cradle

Charges up to four KDC280 or KDC270 devices.

## Pairing Barcodes (if needed)



HID



HID Windows



SPP