

What's in the box?

- ▶ 1 x Galaxy Tab Active2/3/5 SmartSled Case
- ▶ 1 x Hand Strap
- ▶ 6 x Screws + 1 extra (if case only)
- ▶ 1 x KDC480/485 SmartSled and Type-C USB Cable (if KDC480/485 is attached)

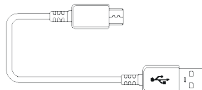
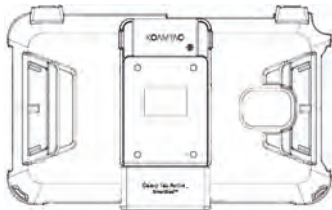

Additional Accessories

- ▶ HF RFID Companion
- ▶ 0.5W UHF RFID Companion
- ▶ 1.0W UHF RFID Companion
- ▶ 2000mAh Extended Battery Companion
- ▶ Pistol Grip Companion (Battery optional)
- ▶ 5-Slot Battery Charger
- ▶ KDC480 1-Slot Charging Cradle
- ▶ KDC480 4-Slot Charging Cradle
- ▶ KDC Pistol Grip 1-Slot Charging Cradle
- ▶ KDC Pistol Grip 5-Slot Charging Cradle



116 Village Blvd, Ste 305, Princeton, NJ 08540
+1 609-256-4700 p | +1 609-228-4373 f
info@koamtac.com | www.koamtac.com



Samsung Galaxy Tab Active® SmartSled® Case Assembly Manual

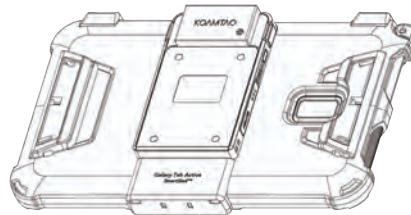

- * PH0 screwdriver may be needed for assembly/disassembly.
- * All pictures shown are for illustration purpose only.
- * Compatible with Tab Active5, Tab Active3, and Tab Active2.
- * Compatible with KDC470/475/480/485.

Assembly Instructions:

If your Galaxy Tab Active Smartsled Case came preassembled with a KDC480/485, please skip step 1 and proceed to step 2.

1. Carefully remove black protective sticker from the back of the KDC SmartSled. Use a Philips-head screwdriver to fasten KDC SmartSled to the SmartSled Case. (A,B)

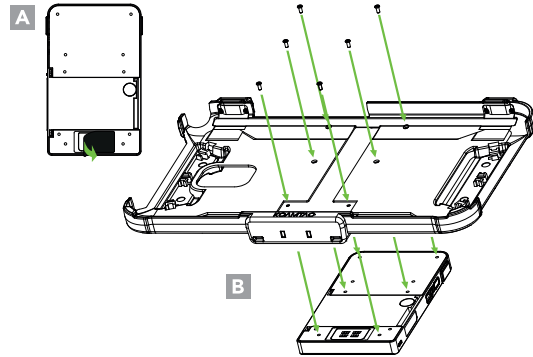

2. Push both of the hand strap's elastic loops through the holes on the back left or back right side of the case. (C) Adjust the length of the hand strap by repositioning the elastic loops onto the various notches inside the case. (D)

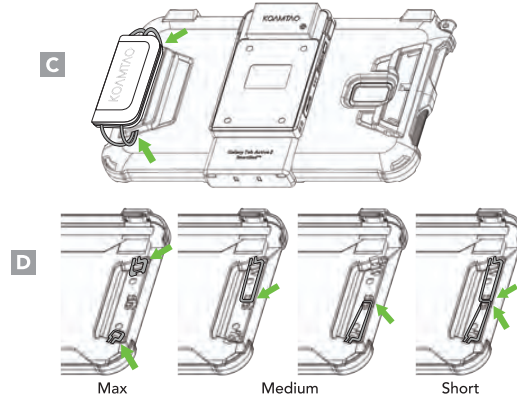

3. With the home buttons to the right, fit the Galaxy Tab Active tablet bottom into the case, as shown. (E) Then, snap the top corners into place. (F)

