



Magnetic Universal Adaptor (MUA) QR Pairing Guide



Contents

- 1. What is QR Pairing? 2
- 2. QR Pairing on Android 2
 - Preparation and Notes 2
 - 2.1 Scan the QR Code 2
 - 2.2 Select Browser (if prompted)..... 3
 - 2.3 Start Pairing 3
 - 2.4 Grant Permissions 4
 - 2.5 Select Device 4
 - 2.6 Confirm Pairing 5
 - 2.7 Completion 5
- 3. QR Pairing on iOS 6
 - Preparation 6
 - 3.1 Scan the QR Code 6
 - 3.2 Open in Bluefly 7
 - 3.3 Start Pairing 7
 - 3.4 Select Device 8
 - 3.5 Confirm Pairing 8
 - 3.6 Completion 9
- 4. Notes 9

1. What is QR Pairing?

QR Pairing is a method of connecting a KOAMTAC device to a host device using a QR code.

The QR code is printed on the MUA. To initiate pairing, open the camera application on the host device (smartphone or tablet) and scan the QR code. The host device will automatically process the encoded information and begin the Bluetooth pairing process with the KOAMTAC device.

This method eliminates manual Bluetooth configuration, providing a faster, more consistent connection, and is ideal for quick setup, multi-device deployment, device re-pairing, shared device environments, and field operations.

2. QR Pairing on Android

Preparation and Notes

Set your phone's default browser to **Google Chrome** (recommended). Google Chrome can be downloaded for free on the Google Play Store.

2.1 Scan the QR Code

1. Open the **Camera app** on your Android device.
2. Point the camera at the **MUA QR code**.
3. Tap the **URL notification** that appears to open the pairing page.

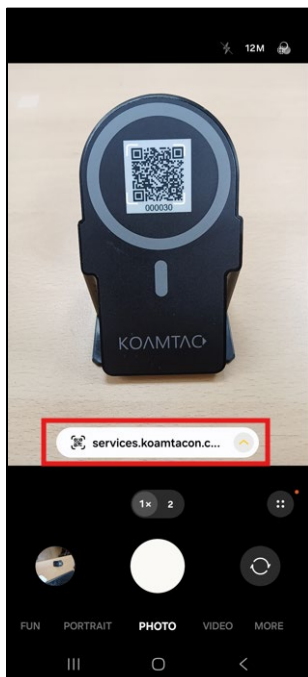

2.2 Select Browser (if prompted)

If your default browser is not Chrome:

- A browser selection screen will appear.
- Select Chrome to continue.

If Chrome is not selected, pairing will not start and an **“Unsupported browser”** message will appear.

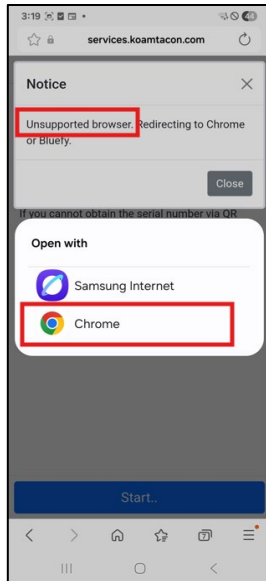

2.3 Start Pairing

When the KOAMTAC pairing page opens, tap the **Start** button.

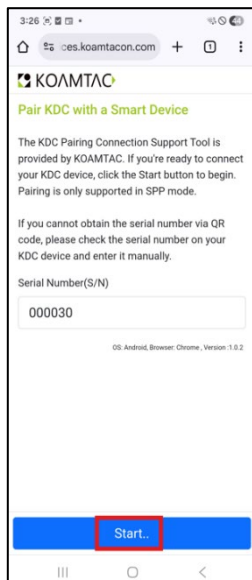

2.4 Grant Permissions

If this is your first time using Chrome for this process:

- Accept the **permission request**.
- Tap **Allow** when prompted.

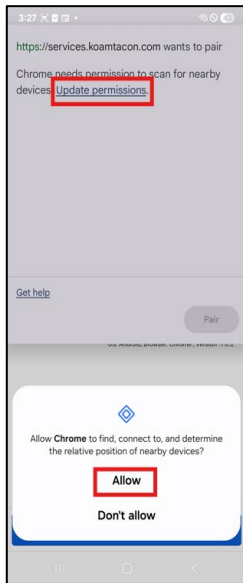

2.5 Select Device

1. The system will search for nearby KDC devices.
2. A list of devices will appear.
3. Select the device with the **matching serial number**, identified by the serial number shown in brackets.
4. Tap **Pair**.

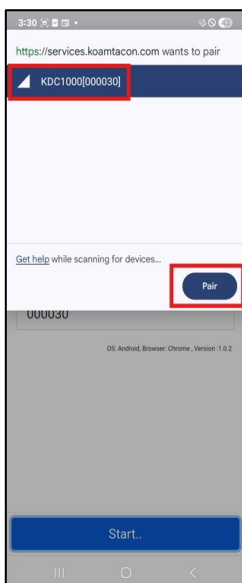

2.6 Confirm Pairing

When prompted, tap **Pair** again to confirm.

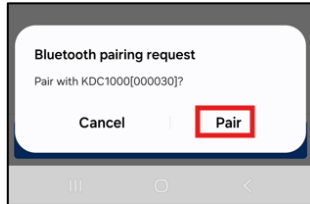

2.7 Completion

Pairing is complete when the confirmation screen appears. Your KDC device is now ready to **connect and use**.

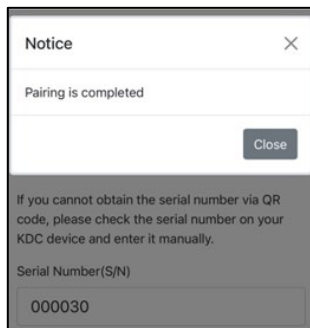

3. QR Pairing on iOS

Preparation

Download and install the **Bluefy Web BLE Browser** from the App Store to enable Bluetooth Low Energy (BLE) web connectivity on your iPhone or iPad.

3.1 Scan the QR Code

1. Open the **Camera app** on your iOS device.
2. Point the camera at the **MUA QR code**.
3. Tap the **URL notification**.

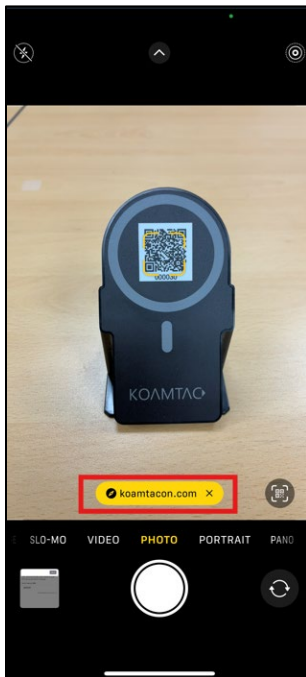

3.2 Open in Bluefly

If Bluefly is **not installed**:

- Pairing cannot proceed.
- Install Bluefly, then restart the process.

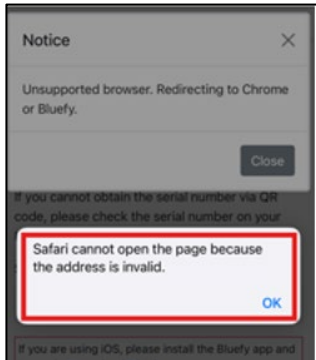

If Bluefly is **installed**:

- Tap **Open** to launch the pairing page in Bluefly.

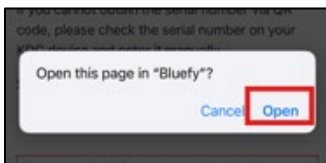

3.3 Start Pairing

Once the KOAMTAC pairing page loads, tap **Start**.

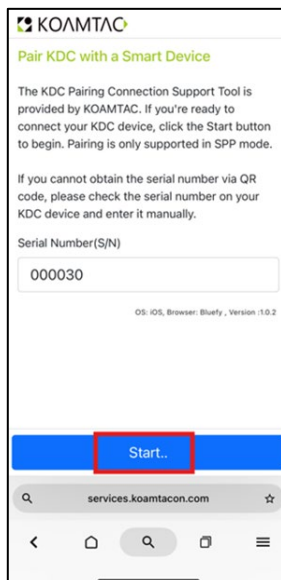

3.4 Select Device

1. The system will search for nearby KDC devices.
2. A list of available devices will appear.
3. Select the correct **KDC device**, identified by the serial number shown in parentheses.

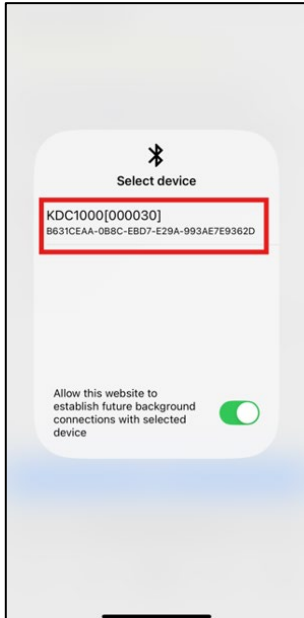

3.5 Confirm Pairing

When prompted, tap **Pair** again to approve the connection.

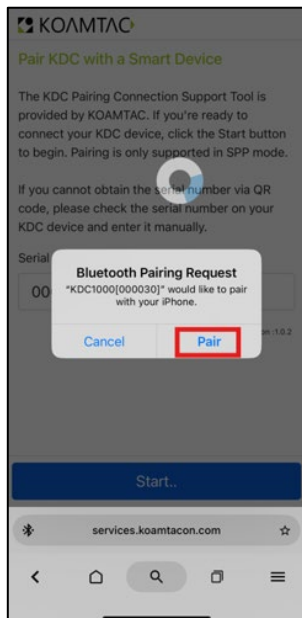

3.6 Completion

Pairing is complete when the confirmation screen appears.
Your KDC device is now ready to **connect and use**.

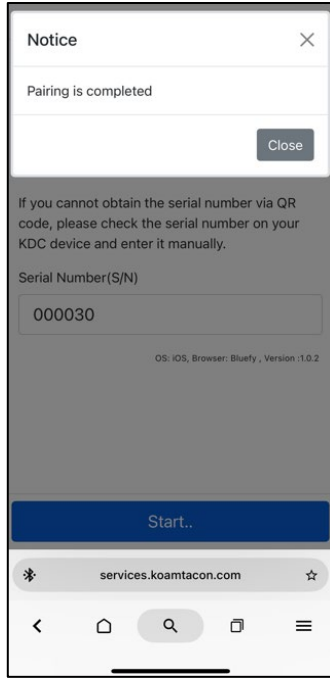

4. Notes

- Ensure **Bluetooth** is enabled on your device before starting.
- Stay within close range of the KDC device during pairing.
- If pairing fails, restart the process from the **Scan the QR Code** step.