

What's in the Box?

- KDC1000/1100 SmartSled + Flat or Angled MUA
- Hand Strap
- Mini Guide
- USB Type-C Cable
- KOAMTACON Guide

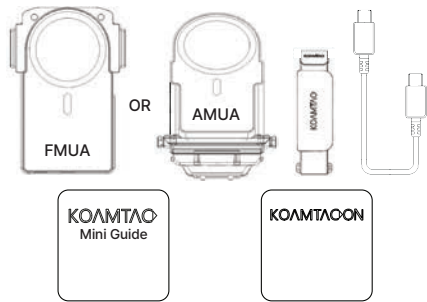

- * Hand Strap is not compatible with the AMUA.
- * KDC1000/1100 units will come pre-installed with the MUA and include pre-assembled Companions if purchased.

Attaching & Removing the FMUA

The FMUA uses a built-in magnetic mount to securely attach the SmartSled to your smartphone. Your phone must have built-in magnetic alignment or use a compatible magnetic case.

1. Hold your phone face-up and parallel to the FMUA, then slowly lower it toward the surface.
2. The magnets will guide the device into alignment. It will snap firmly into place without force.
3. To Remove, grip the phone firmly on both sides and pull directly away from the FMUA with steady, even pressure. Do not twist or pry.

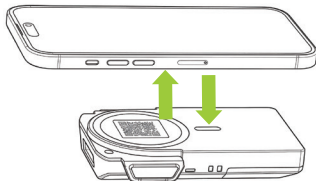

Powering Your SmartSled On/Off

Press and hold both the left and right SCAN buttons for 3 seconds to power the KDC1000/1100 SmartSled ON.

Repeat this step to power the device OFF.

The SmartSled will beep when turned ON or OFF.

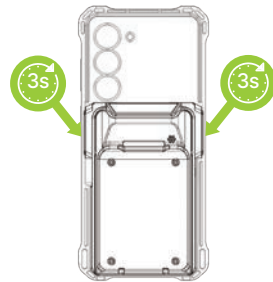

Attaching & Removing the AMUA

The AMUA's magnetic mount securely holds your smartphone. Devices with magnetic alignment or a compatible case will attach easily.

1. With your phone face-up, align it parallel to the AMUA and gently bring it toward the surface.
2. The magnetic system will draw the device into position and hold it securely in place.
3. To remove, firmly grasp both sides of the phone and pull it straight away from the AMUA with consistent pressure. Avoid any twisting or angled force.

- * AMUA depicted with 1W UHF Reader for illustration purposes. The attachment process is the same when using the Pistol Grip.

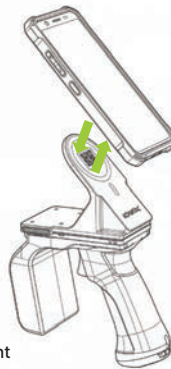

Additional Accessories

- 0.5W/1.0W UHF Companion
- Extended Battery
- mPOS & MSRIC Companion
- 1/2-Slot and 10-Slot Charging Cradles Compatible with MUA
- Pistol Grip Companion

Available Models for FMAU and AMUA:

- KDC1000 ST Flat Magnetic Universal Adaptor SmartSled
- KDC1100 ST Flat Magnetic Universal Adaptor SmartSled
- KDC1100 PRO Flat Magnetic Universal Adaptor SmartSled
- KDC1000 ST Angled Magnetic Universal Adaptor SmartSled
- KDC1100 ST Angled Magnetic Universal Adaptor SmartSled
- KDC1100 PRO Angled Magnetic Universal Adaptor SmartSled



100 Village Blvd Ste 300, Princeton, NJ 08540
+1 609-256-4700 p
info@koamtac.com | www.koamtac.com

Bluetooth Pairing via Device QR Code

Ensure your smartphone has a compatible browser installed and set as the default:

Android: Chrome | iOS: Bluefy Web BLE browser

All Bluetooth and browser permissions when prompted.

1. Open your phone's camera app and scan the QR code on the MUA.
2. Tap the link that appears in the camera app to open the KOAMTAC pairing page in the browser.
3. Tap the Start button in the browser to search for nearby KDC devices.
4. Select the KDC1000/1100 with the matching serial number and tap Pair.
5. Tap Pair on the pop-up to complete Bluetooth pairing.

- * The SmartSled will beep when pairing is successful and ready to use.

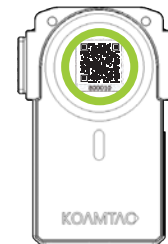

KDC1000/1100 + MUA

Mini Guide



For details on warranty, certifications, and legal compliance, please refer to koamtac.com and the Reference Manual.

Basic Operation

Aim the SmartSled at the barcode and press either SCAN button located on the sides of the device. Barcodes can be scanned from any direction. Depending on the scan engine, the aimer may appear as a cross, dot, or line.

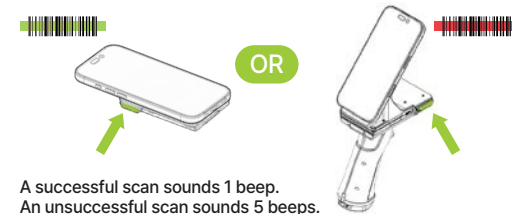

A successful scan sounds 1 beep.
An unsuccessful scan sounds 5 beeps.

The external USB Type-C port on the SmartSled is used for charging via a USB cable and for PC connectivity.



Bluetooth Profiles

Bluetooth is available on the KDC1000/1100 SmartSled, but not the default communication method.

HID

Allows one-way Bluetooth communication with an Android or iOS host device. The SmartSled only transmits data to the host device.

SPP

Allows two-way Bluetooth communication. The SmartSled transmits data to the host device and the host device can transmit data back to the SmartSled.

HID inputs data directly into an application. SPP requires the KOAMTAC KTSync® app or integration of the KOAMTAC SDK to input data into an application.

KOAMTACON

The first application suite of its kind, KOAMTACON is a data collection cloud suite designed specifically to be used with KDC barcode scanners, RFID readers, and magnetic stripe readers (MSR) to collect data in any situation.

With apps ranging from ticketing to warehouse management, KOAMTAC has you covered. It's never been so easy to collect data via barcodes, RFID, or magnetic stripe.

KOAMTACON is:

- Simple to maintain
- Easy to use
- Cloud-based
- Compatible with any device

For more information please visit:

www.koamtac.com



Additional Bluetooth Pairing Barcodes



BLE SPP



BLE HID

KDC1000/1100 Diagram

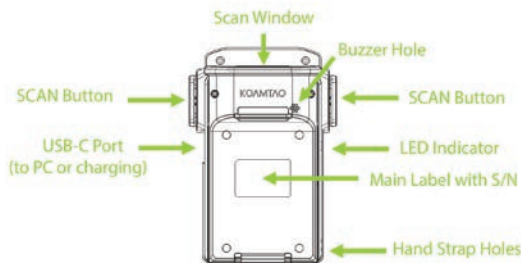

KDC1100 models are identical except for their angled scan engines.

Using Keyboard Wedge

Keyboard wedge allows you to use your KDC1000/1100 SmartSled as a keyboard. The HID profile works as keyboard wedge by default. When using the SPP profile, KTSync provides a keyboard wedge function when KTSync keyboard is enabled. Please refer to the KDC Reference Manual for detailed instructions to enable KTSync keyboard.

1. Ensure that the KDC1000/1100 SmartSled is connected to the host device using the HID profile or the SmartSled is connected via KTSync keyboard using the SPP profile.
2. Open any application on the host device that contains a text field you want to populate.
3. Tap the text field in the application.
4. Scan any barcode with the SmartSled.
5. The barcode data will then populate in the text field.

Additional Resources

For product specifications, detailed documentation, setup guides, and support resources for the MUA and KDC1000/1000 SmartSled, visit koamtac.com.

The KOAMTAC website is regularly updated with the latest product information, firmware updates, and compatible accessories.

For step-by-step video guides, product walkthroughs, and tutorials covering the full range of KOAMTAC devices, visit the official KOAMTAC channel on YouTube at youtube.com/user/koamtac.

KTSync & SDK

KTSync® is a program which communicates with the KDC1000/1100 via Bluetooth. It enables users to read and store data. KTSync is compatible with iOS, Android, Windows, and Mac. It also supports wedging and downloading data from the SmartSled.

For more information about KTSync, please visit:

www.koamtac.com/support/downloads/applications

The Software Development Kit (SDK) is the perfect solution for creating a custom application to collect data utilizing your SmartSled. The KOAMTAC SDK covers all major development platforms: Android, iOS, Windows, Xamarin, Cordova, React Native, and Flutter. Developers may take advantage of the complimentary SDK and enjoy the full benefits of the KOAMTAC Developer Program. For more information regarding the KOAMTAC Developer Program or to request the latest SDKs, visit:

www.koamtac.com/support/downloads/sdk
or e-mail sdm@koamtac.com.

Additional Resources

